



Always being made New.

25 YEARS TOGETHER IN CHRIST

Program



Evangelical Lutheran Church in America
God's work. Our hands.

2013 ELCA Churchwide Assembly

Assembly at a Glance

Assembly Directory	3
Officers	3
Church Council	3
Parliamentarian	3
Advisory Members	3
Separately Incorporated Ministries	4
Committees of the Churchwide Assembly	4
Other Committees	5
Assembly Staff	5
Ecumenical, Invited, and International Guests	6
General Information	8
Acknowledgments	8
Assembly Information	9
Special Events	11
Materials	14
Meals	15
People Helping People	16
Living Well–All Week Long	16
Worship	17
Caring for Creation	21
Downtown Pittsburgh Map	23
Convention Center Map	24
Seating Chart Key	25
Seating Chart	26

Assembly Directory

Churchwide Officers

Presiding Bishop: Bp. Mark S. Hanson
Vice President: Mr. Carlos E. Peña
Secretary: Mr. David D. Swartling
Treasurer: Pr. Linda O. Norman

Church Council

Mr. Paul G. Archer
Ms. Marit L. Bakken
Mr. Nicholas Barber
Ms. Rebecca Jo (“Becky”) Brakke
Ms. Deborah L. Chenoweth
Ms. Christine P. Connell
Pr. Rachel L. Connelly
Bp. Jessica Crist
Pr. Elizabeth Ekdale
Ms. Marjorie Ellis
Mr. John R. Emery
Mr. Gary D. Gabrielson
Pr. Vicki T. Garber
Pr. Amsalu T. Geleta
Ms. Karin Lynn Graddy
Pr. Joyce M. Graue
Ms. Louise A. Hemstead
Pr. Stephen R. Herr
Mr. William B. (“Bill”) Horne II
Mr. Mark E. Johnson
Pr. Susan Langhauser
Pr. Yvonne I. Marshall
Ms. Susan W. McArver
Pr. Raymond A. Miller
Pr. Robert Moore
Mr. John S. Munday
Mr. Mark W. Myers
Mr. John M. Pederson
Ms. Pamela E. Pritt
Ms. Feronika A. Raming
Pr. Laurie F. Skow-Anderson
Pr. Kathryn A. Tiede
Pr. Philip R. Wold

Parliamentarian

Mr. John Sleasman

Advisory Members

Office of the Presiding Bishop

Presiding Bishop: Bp. Mark S. Hanson
Executive for Administration: Pr. M. Wyvetta Bullock
Executive for Discernment of Contextual and Theological Issues: Pr. Marcus R. Kunz
Executive for Ecumenical and Inter-Religious Relations: Pr. Donald J. McCoid
Assistant to the Presiding Bishop for Governance: Ms. Jodi L. Slattery
Executive for Human Resources: Ms. Else B. Thompson
Executive for Research and Evaluation: Mr. Kenneth W. Inskeep
Executive for Synodical and Constituent Relations: Pr. Walter S. May Jr.
Assistant to the Presiding Bishop for Federal Chaplaincy Ministries: Pr. F. Eric Wester

Office of the Secretary

Secretary: Mr. David D. Swartling
Assistant Secretary: Ms. Sue E. Rothmeyer
Executive for Assembly Logistics, Meeting Management, and Travel: Ms. Mary Beth Nowak
General Counsel: Mr. Phillip H. Harris
Associate General Counsel: Mr. David A. Ullrich

Office of the Treasurer

Treasurer: Pr. Linda O. Norman
Budget Director: Mr. Gary K. Brugh
Executive for Information Technology:
Mr. Jonathan H. Beyer

Congregational and Synodical Mission Unit

Executive Director: Pr. Stephen P. Bouman

Global Mission Unit

Executive Director: Pr. Rafael Malpica Padilla

Mission Advancement Unit

Executive Director: Ms. Christina Jackson-Skelton

Separately Incorporated Ministries

Publishing House of the Evangelical Lutheran Church in America (Augsburg Fortress, Publishers)

Board Chair: Ms. Linda J. Brown
President: Ms. Beth A. Lewis

Lutheran Men in Mission

Board President: Mr. Richard White
Director: Mr. Douglas H. Haugen

Women of the ELCA

President: Ms. Jennifer Michael
Executive Director: Ms. Linda Post Bushkofsky

Portico Benefit Services

Board Chair: Mr. Michael J. McCoy
President: Pr. Jeffrey D. Thiemann

Church Periodical (*The Lutheran Magazine*)

Advisory Committee Chair: Ms. Carol A. McDivitt
Editor: Mr. Daniel J. Lehmann

Mission Investment Fund of the ELCA

Board Chair: Mr. Daniel M. Bringman
President: Ms. Eva M. Roby
Executive Vice President: Mr. John S. Spear

Endowment Fund of the ELCA

Board Chair: Mr. John H. Saeger
President: Ms. Christina Jackson-Skelton

Deaconess Community

Board Chair: Sr. Noreen Stevens
Executive Director: Ms. Barbara Swartling

Committees of the Churchwide Assembly

Memorials Committee

Sr. Krista Anderson
Pr. Jane Buckley-Farlee
Bp. Elizabeth Eaton
Mr. Walter Gwenigale

Pr. Stephen Herr, *co-chair*
Mr. Raymond Huff
Mr. Mark Johnson
Pr. Mark Kvale
Ms. Rachel Line
Ms. Susan McArver, *co-chair*
Pr. Kendra Mohn
Mr. Charles Pietscher
Mr. Anthony Rhodes
Pr. Laurie Skow-Anderson
Bp. Ray Tiemann

Reference and Counsel Committee

Bp. Jon Anderson
Mr. Paul Archer
Ms. Amanda Briggs
Ms. Addie Butler
Pr. Vicki Garber
Ms. Louise Hemstead, *co-chair*
Mr. William Horne, *co-chair*
Ms. Jessica Hrabovsky
Mr. Charles Poston
Pr. Rebecca Sheridan
Pr. Randy Skow-Anderson
Ms. Yolanda Tanner
Mr. Carl Teinert
Pr. Glen Vanderkloot
Bp. Martin Wells

Nominating Committee

Mr. Ken F. Aicher
Pr. Herbert E. Anderson
Ms. Gwen E. Arneson
Ms. Susan M. Berg
Mr. Baron Blanchard, *vice chair*
Ms. Linda M. Chinnia
Pr. Jonathan L. Eilert, *chair*
Mr. James M. Hushagen
Mr. Brandon W. Huston
Ms. Emily Isensee
Ms. Kathy J. Magnus
Pr. Loren D. Mai
Pr. Kathie Bender Schwich
Ms. Judith A. Tutt-Starr
Ms. Vernetta Wilson

Other Committees

Ad Hoc Committee

Bp. Julian Gordy
Pr. Marcus R. Kunz
Pr. Yvonne I. Marshall
Mr. John S. Munday, *co-chair*
Ms. Cynthia Osborne, *co-chair*
Ms. Pamela E. Pritt
Pr. Roger A. Willer

Churchwide Assembly Planning Committee

Mr. Jonathan Beyer
Mr. Forrest Meyer
Mr. John J. Hessian III
Ms. Christina Jackson-Skelton
Mr. Philip Miller
Mr. Brett Nelson
Ms. Mary Beth Nowak
Pr. Peter Perella
Ms. Melissa Ramirez Cooper
Ms. Laury Rinker
Ms. Sue E. Rothmeyer
Ms. Jodi Slattery, *chair*
Mr. David D. Swartling
Mr. Scott C. Weidler

Credentials Committee

Ms. JoAnne N. Brady, *registrar*
Mr. David D. Swartling, *ex officio chair*
Mr. David A. Ullrich, *vice chair*

Elections Committee

Mr. Phillip H. Harris, *chair*
Mr. Kenneth Inskip
Ms. Deborah K. Myers, *vice chair*
Mr. Daniel S. Taylor
Mr. David A. Ullrich

Local Arrangements Committee

Mr. Terry Caywood
Ms. Barbara Debski
Pr. Brian A. Evans
Pr. Erin Evans
Ms. Janet Franzen
Pr. Martin J. Galbraith
Pr. Janet B. Grill
Ms. Janice Jeletic
Mr. Dennis T. Lane

Pr. Sarah M. Lee-Faulkner
Ms. Sylvia Lynn
Ms. Janet J. Montelaro, *co-chair*
Pr. Jane C. Nicholson
Ms. Mary Beth Nowak, *assembly manager*
Mr. Edward W. Sites, *co-chair*
Pr. Melissa L. Stoller
Ms. Lori Tormey
Mr. Ralph Travis

Minutes Team

Pr. Susan L. Gamelin
Mr. Frank F. Imhoff, *editor*
Ms. Cynthia Johnson
Pr. James G. Krauser
Ms. Catherine Lundeen
Pr. Thomas E. McKee
Ms. Sue E. Rothmeyer, *vice chair*
Pr. William J. Sappenfield
Mr. David D. Swartling, *ex officio chair*

Assembly Staff

Assembly Manager: Ms. Mary Beth Nowak
Assembly Assistants:
 Ms. Katharine V. English
 Ms. Meredith O'Brien
Registrar: Ms. JoAnne N. Brady
Registration Supervisor: Ms. Gail L. Schroeder
Registration Assistants:
 Ms. Emma Harbin
 Ms. Rosa Perez
 Ms. Natalie Young
Secretary's Deputy: Ms. Sue E. Rothmeyer
Deputy's Assistant: Pr. Jonathan Eilert
Text Projection: Pr. Marcus R. Kunz
 Pr. Roger A. Willer
Guidebook Projection: Pr. Gordon J. Straw
Assembly Office Managers:
 Ms. Wendy E. Blanck
 Ms. Emma Harbin
Shipping Manager: Ms. Emma Harbin
Shipping Assistants:
 Ms. Meredith O'Brien
 Ms. Rosa Perez
Materials Distribution:
 Ms. Terri Endres
 Ms. Carol Ostrem

Cashiers:

Ms. Barbara Young
Mr. Jeremy Harbison

Meal Cards:

Mr. Robert Benson
Ms. Barbara Swartling

Offering Counter: Mr. Gary Brugh

Stage Manager: Ms. Tammy Jackson

Microphone Cuing: Mr. Joel Thoreson

Assembly Sergeant at Arms: Pr. Kathie Bender
Schwich

Assistant Sergeants at Arms:

Pr. Daniel Schwick
Pr. Paul Ostrem

Computer Support Manager: Mr. Jonathan H.
Beyer

Computer Support:

Mr. Andrew Bosch
Mr. Joseph L. Clairmont
Mr. Paul Edison-Swift
Ms. Kathleen Grzeczka
Mr. Ronney N. Hunter
Ms. Kristin Koskinen
Mr. Len Mason
Mr. Michael McCorkle
Ms. Judith Schirmer
Mr. Suhail Qumri

Copy Center Staff:

Ms. Eliza Alvarez, *supervisor*
Mr. Timothy T. Doss

Reference and Counsel Committee Staff:

Ms. Tchad Harris
Pr. Walter S. May Jr.

Memorials Committee Staff:

Mr. John J. Hessian III
Ms. Jodi L. Slattery

Nominations Desk:

Ms. Katharine English

Assembly Communication

Electronic and Video Support:

Executive Producer: Mr. Forrest Meyer

Producer: Mr. Brett Nelson

Line Producer: Ms. Emerald Jane Hunter

Floor Manager: Ms. Laury Rinker

Graphics: Mr. Tim Kolb

Public Relations:

Public Relations Manager: Ms. Melissa Ramirez
Cooper

Media Relations Specialist: Ms. Candice Hill
Buchbinder

Social Media Specialist: Ms. Janice R. Rizzo

Social Media Support: Mr. Neal Fischer

Digital and Internet Support:

Digital Media Manager: Mr. Philip Miller

Digital and Social Media Support: Ms. Reva
Hardina

Web and Guidebook Specialist: Ms. Kristin
Koskinen

Web Specialist: Ms. Tracie Watkins

Photographer: Ms. Karen Dersnah

Ecumenical Guests

Bishop George Edward Battle Jr., *senior bishop,*
African Methodist Episcopal Zion Church

The Rev. John Bradosky, *bishop, North*
American Lutheran Church

The Rev. Mark Chavez, *general secretary,*
North American Lutheran Church

Rabbi Steve Gutow, *President and CEO, Jewish*
Council for Public Affairs

The Reverend Thomas Hay, *Associate Stated*
Clerk of the Presbyterian Church USA

The Most Rev. Dr. Katharine Jefferts Schori,
presiding bishop, Episcopal Church

The Rev. Susan C. Johnson, *national bishop,*
Evangelical Lutheran Church in Canada

Ms. Natasha Klukach, *programme executive*
church and ecumenical relations, World
Council of Churches

Bishop Denis J. Madden, *auxiliary bishop of*
Baltimore, chair of ecumenical and
interreligious relations, U.S. Conference of
Catholic Bishops

Mr. Tracy Merrick, *Consultant to the*
Ecumenical Staff Officer, United Methodist
Church

The Rev. Dr. Elizabeth D. Miller, *president,*
Moravian Church in America–Northern
Province

Dr. John Roth, *Professor of History, Goshen*
College, Mennonite Church USA

Dr. Tarunjit Singh Butalia, *Former Secretary General, World Sikh Council – American Region*

The Rev. Dr. Jack Sullivan Jr., *Regional Minister and President, The Pennsylvania Region of the Christian Church (Disciples of Christ) in the United States and Canada*

Dr. Sayyid Syeed, *Alliances Director, Islamic Society of North America Office of Interfaith and Community*

The Rev. Karen Georgia Thompson, *minister for ecumenical relations, United Church of Christ*

The Rev. Dr. Olav Tveit, *general secretary, World Council of Churches*

The Rev. Dr. Heather Hartung Vacek, *Assistant Professor of Church History, Pittsburgh Theological Seminary, Moravian Church in America – Southern Province*

The Rev. Lisa Vander Wal, *former president of the general synod, Reformed Church in America*

Bishop George W.C. Walker Sr., *African Methodist Episcopal Zion Church*

The Rev. David Wendell, *assistant to the bishop, North American Lutheran Church*

The Rt. Rev. Dr. Munib A. Younan, *President, the Lutheran World Federation, and Bishop, Evangelical Lutheran Church in Jordan and the Holy Land (ELCJHL)*

Invited Guests

Mr. George Aker and Ms. Mary Aker, *former ELCA treasurer and spouse*

Pr. H. George Anderson, *former ELCA presiding bishop (unable to attend)*

Pr. Lowell G. and Ms. Sally C. Almen, *former ELCA secretary and spouse*

Ms. Kathryn W. Baerwald, *Commission for a New Lutheran Church*

Pr. Darold H. Beekman, *Commission for a New Lutheran Church*

Ms. Addie Butler, *former ELCA vice president*

Pr. Herbert W. and Pr. E. Corinne Chilstrom, *former ELCA presiding bishop and spouse*

Pr. James Crumley, *former Lutheran Church in America bishop (unable to attend)*

Ms. Charlotte Haberaecker, *president, Lutheran Services in America*

Ms. Linda Hartke, *president, Lutheran Immigration and Refugee Services*

Ms. Christine Grumm, *former ELCA vice president*

Ms. Christina Jackson-Skelton and Mr. Timothy Skelton, *former ELCA treasurer and spouse*

Ms. Kathy Magnus and Pr. Richard Magnus, *former ELCA vice president and spouse*

Pr. John A. Nunes, *president, Lutheran World Relief*

Pr. David Preus, *former American Lutheran Church president (unable to attend)*

Pr. Howard D. Stendahl, *chief of chaplains of the U.S. Air Force*

International Guests

Bishop Phillip Lok, *Lutheran Church in Malaysia and Singapore*

The Rev. Rakoto Modeste, *president, Malagasy Church*

General Information

Acknowledgments

Gratitude is expressed to the following for their generous support of the 2013 Churchwide Assembly:

Bishop Murray Finck

- Sponsorship of Stretch and Pray

Church Mutual Insurance Company:

- Pre-assembly dinner for the Church Council, Conference of Bishops, synod vice presidents, and churchwide executives

Mission Investment Fund of the Evangelical Lutheran Church in America:

- Coffee mugs
- iPad stylus with pen and light
- 25th Anniversary bookmarks

Portico Benefits Services:

- Lunch bags
- Genius charging station
- Bishops' assistants, synod treasurers, and synod vice presidents lunch

Thrivent Financial for Lutherans:

- Furniture used at the assembly, which will be donated after the assembly
- Pre-assembly dinner for the Church Council, Conference of Bishops, synod vice presidents, and churchwide executives

Synod Gift

In honor of the 2013 Churchwide Assembly and of Pittsburgh having been named America's most bicycle friendly city, the Southwestern Pennsylvania Synod has refurbished 43 bicycles and purchased 43 helmets. The Boys & Girls Club in McKeesport, Pa., will identify the youth who will be receiving the bicycles and helmets.

Additional Acknowledgments

Special thanks are expressed to:

- Members of the Local Arrangements Committee, who worked tirelessly and donated countless hours in preparation for this event;
- Staff members of the David L. Lawrence Center for assisting with the arrangements; and
- Best Travel for facilitating air-travel arrangements.

Volunteers

Thank you to all of the assembly volunteers, many of whom have paid their own way and are using personal time to be in Pittsburgh, for all of their work during this assembly. This assembly could not have happened without their dedication and love for this church.

Assembly Information

Assistance

If assistance is needed with directions or other questions during the course of the assembly, please ask one of the many local volunteers wearing red vests.

Office Locations

Maps are located around the convention center. The following are located at the convention center:

Assembly Office	Room 333
Augsburg Fortress Bookstore	Hall B
Comfort Station	Hall B
Computer Support and Web Team	Room 336
Local Arrangements Committee	Room 330
<i>The Lutheran Magazine</i>	Room 328
Media Relations	Room 328
News Conference	Room 329
Nominations Desk (<i>see page 11 for hours</i>)	Room 333
Portico Benefit Services	Hall B
Registration	Outside Hall B
Stretch and Pray	Next to Registration
Volunteer Check-in	Room 330

Business Center

Each hotel offers its own business center. Please check with your hotel to see what specific services are available.

Electronic Device Usage in Plenary Hall

Electronic devices will be permitted in the plenary hall provided their use does not disturb others. See the Rules of Organization and Procedure for more details.

In addition, most voting members will be using iPads and other tablet devices to access the *Pre-Assembly Report*. A very limited number of electrical outlets will be available in the plenary hall. Please charge electronic devices overnight in your hotel rooms.

Email Access

Wi-Fi is available throughout the convention center to gain access to your email.

Flier Distribution

The David L. Lawrence Convention Center maintains a strict policy on the distribution of fliers and posting of notices. The distribution of fliers is strictly prohibited throughout the convention center. Additionally, decorations, signs, banners, or similar materials may not be taped, nailed, tacked, stapled, or otherwise fastened to ceilings, doors, walls, glass, columns, painted surfaces, fabric or decorative walls, railings, ceiling tiles, or light fixtures. Banners and other decorating materials are to be hung only in approved locations.

Hearings

Hearings will be held on Tuesday, August 13, on major action items before the assembly and other current issues. The purpose of the hearings is to provide additional information and to answer questions about the various initiatives and recommendations prior to floor consideration. Voting members will choose which hearing they will attend on a “first - come” basis. Interested visitors will be able to observe the hearings as space permits. Under the assembly’s rules, only voting members, resource members, advisory members, and official visitors have voice in the hearings.

5:00 P.M.–6:00 P.M.

- 25th Anniversary Campaign Room 315/316
- 2014-2016 Budget Room 321
- ELCA World Hunger Room 306/307
- Proposed Social Statement on Criminal Justice Room 310/311
- Healthcare Reform - Portico Benefits Services Room 302/303/304/305

7:00 P.M.–8:00 P.M.

- Addressing Social Concerns Review Room 319
- LIFT: Mission Planning Room 320
- Women and Justice social statement listening event Room 310/311
- ELCA Malaria Campaign Room 306/307
- Communal Discernment Room 321
- Healthcare Reform - Portico Benefits Services Room 302/303/304/305
- 25th Anniversary Campaign Room 315/316

Chairs of boards and committees, unit staff members, and others who have worked with specific hearing topics will be present as resource people. The convener, a member of the Church Council, will invite a brief opening presentation by the unit responsible for the proposed action. General discussion will follow. The hour-long hearings are non-legislative in nature. Although during the hearings voting members cannot offer motions or resolutions for assembly action, varying viewpoints may be expressed.

“I Love to Tell the Story: My ELCA”

As part of the larger *Voices of Vision* oral history project, the ELCA is hoping assembly participants will share stories about the ELCA at its “I Love to Tell the Story: My ELCA” video booth, located in room 332. Fifteen-minute time slots will be available for participants to sit down and record their memories, thoughts, joys, or challenges of the first 25-plus years of the ELCA.

Guidebook Users

Voting and advisory members who are using the ELCA Guidebook application will receive an iPad on loan after registration unless they have indicated that they will bring their own electronic device. Orientation for these users will be on Monday, August 12, at 1:30 P.M. iPads can be picked up when the registration desk is open. Each member utilizing an iPad provided on loan will need to sign a user agreement when the iPad is checked out.

There will be limited access to electrical outlets in the convention center, so please be sure to charge the iPads overnight in your hotel rooms.

Technical support will be available for Guidebook users during plenary sessions. There will be Guidebook support desks in the plenary hall staffed by volunteers and technology support team members to assist with any issues that you have utilizing the ELCA Guidebook application. Volunteers will be wearing a yellow shirt.

There will also be a Guidebook support area in Hall B for technical assistance outside of plenary sessions. The hours of the Guidebook support area are:

Monday, August 12	9:00 A.M. – 7:00 P.M.
Tuesday, August 13	7:00 A.M. – 7:00 P.M.
Wednesday, August 14	7:00 A.M. – 6:30 P.M.
Thursday, August 15	7:00 A.M. – 6:30 P.M.
Friday, August 16	7:00 A.M. – 6:00 P.M.
Saturday, August 17	7:00 A.M. – 12:00 P.M.

All iPads provided on loan must be returned promptly after the close of the assembly, or else the user is subject to a charge.

Legislative Advice Desk

Legislative advice is provided at the secretary's deputy station just to the left of the podium in the plenary hall one-half hour before and after each plenary session. Staff will be available to answer questions on parliamentary procedure and assist in the process of presenting motions from the floor.

Lost and Found

The Lost and Found is located in the Assembly Office, Room 333.

Nominations Desk

The Nominations Desk is located in the Assembly Office, Room 333. The desk is open the following hours:

Monday, August 12	8:30 A.M.–9:30 P.M.
Tuesday, August 13	8:00 A.M.–11:00 A.M.

Shuttle Service from the Wyndham to the Convention Center

The ELCA will be providing shuttle service to and from the convention center for guests staying at the Wyndham. The shuttle will pick up and drop off from the Wyndham at the corner of Commonwealth and Liberty (walk left out of the front door of the hotel) and from the convention center at the east entrance. The shuttle will run continuously during the following times:

Monday, August 12:	12:30 P.M. – 9:45 P.M.
Tuesday, August 13:	7:00 A.M. – 9:00 A.M. 8:00 P.M. – 9:15 P.M.
Wednesday, August 14:	7:00 A.M. – 9:00 A.M. 6:30 P.M. – 8:15 P.M.
Thursday, August 15:	7:00 A.M. – 9:00 A.M. 6:30 P.M. – 8:15 P.M.
Friday, August 16:	7:00 A.M. – 9:00 A.M. 7:45 P.M. – 9:15 P.M.
Saturday, August 17:	7:00 A.M. – 9:00 A.M.

Check at the assembly registration desk beginning on Thursday, August 15 for details on the shuttle schedule to the airport on Saturday, August 17.

Special Events

Augsburg Fortress Event Store

Join Augsburg Fortress in celebrating 25 years as the publishing ministry of the Evangelical Lutheran Church in America. Learn about and purchase many new resources and books for individuals and congregations, including:

- Holy Moly—the innovative, interactive curriculum for children grades K–4
- Connect—the Bible-centered Sunday school tailored to tweens grades 5–6
- Echo the Story—a story-based curriculum that gives teens a deep experience of the Bible
- Animate—an in-depth exploration of Christianity's big questions for adults
- Prelude—the multi-publisher music library with instant downloads

While you're visiting the store, register to win a \$100 Augsburg Fortress gift card. Winners will be drawn daily, so register early for more chances to win.

Store Hours:

Monday, August 12:	10:00 A.M.–7:30 P.M.
Tuesday, August 13:	7:30 A.M.–7:00 P.M.
Wednesday, August 14:	7:30 A.M.–6:30 P.M.
Thursday, August 15:	7:30 A.M.–6:00 P.M.
Friday, August 16:	7:30 A.M.–6:30 P.M.
Saturday, August 17:	7:30 A.M.–2:00 P.M.

Coffee

Coffee is available at the Augsburg Fortress Event Store in Hall B, Tuesday–Friday, 9:00 A.M.–11:00 A.M. Out of concern for the environment, no disposable cups will be provided. Instead, complimentary mugs will be distributed during the afternoon plenary session on Monday, August 12, for use throughout the week.

Presidents' Reception

ELCA college, university, and seminary presidents invite Churchwide Assembly participants to a reception on Wednesday, August 14, at 6:30 P.M. in Concourse C. The presidents of these ELCA institutions welcome the opportunity to engage voting members and guests in informal conversation about the ELCA's partnerships in education for service in church and the world. Hors d'oeuvres, beer, and wine will be served. (Alcohol will only be served to those who are at least 21 years old with proper identification.)

25th Anniversary Celebration

Celebrate 25 years together in Christ as the Evangelical Lutheran Church in America at the special anniversary banquet dinner and music festival program on Friday, August 16. Festivities begin at 6:30 P.M. in the Spirit of Pittsburgh Ballroom in the convention center. A cash bar will be available. (Alcohol will only be served to those who are at least 21 years old with proper identification.)

After dinner, all will enjoy an evening of singing together in creative ways: well-known songs and hymns and some newer to our growing memory bank, but all loved. Participants can anticipate energy, fun, and surprise, led by two musical servants of the ELCA – Mark Sedio and David Cherwien – assisted by the assembly's worship musicians, and, of course, the assembly itself.

David Cherwien is cantor at Mount Olive Lutheran Church in Minneapolis, Minn., and artistic director of the National Lutheran Choir, also based in the Twin Cities. A native Minnesotan (and Lutheran) he has studied and served churches in Berlin, Seattle, Chicago, and Minneapolis. He has published music for worship and serves the church at large providing hymn festivals and workshops in many states.

Mark Sedio is an associate in ministry and cantor at Central Lutheran Church in Minneapolis, Minn. From 1985-2008 he was staff musician at Luther Seminary (St. Paul, Minn.). He has also held positions at Mount Olive Lutheran Church (Minneapolis, Minn.), Augsburg College, Gustavus Adolphus College, and St. Paul Lutheran Church (Davenport, Iowa).

"Celebrating God's Global Church" Breakfast

This breakfast celebrating the church's global engagement and honoring ELCA missionaries and those who support them will take place on Thursday, August 15, 6:30 A.M. – 7:40 A.M. in the Westin Hotel's 3rd floor ballroom. Guests will hear an update on the work of ELCA missionaries and learn about new sponsorship opportunities that support a fuller picture of our church's global engagement, including opportunities to directly support Young Adults in Global Mission volunteers and scholarships for International Leaders and Global Ministries with our companions in Christ. They will see a festive display of Global Linked pennant streamers signed by people from across the ELCA. Registration is limited. Voting members must RSVP by contacting globalchurch@elca.org.

Highlighting and Affirming Ministry Partners Reception

All assembly participants are invited to a joint reception held on Thursday, August 15, with the Congregational and Synodical Mission and Global Mission units of the churchwide organization.

Music entertainment will kick-off the reception in the Spirit of Pittsburgh Ballroom in the convention center at 6:00 P.M. Let's share the grace of God in Christ with one another and discover more about the meaning of "accompaniment" as a way of life in which we are more attentive to relationships in our congregations, throughout our communities, and around the world. Light hors d'oeuvres and refreshments will be served. A cash bar will also be available. (Alcohol will only be served to those who are at least 21 years old with proper identification.)

Stained Glass Window Project – Your Help is Needed!

Artist Dennis Roberts, of Fredericksburg, Texas, has designed a pattern, created the frame, and pre-cut glass for a stained glass window for a new ELCA congregation. Assembly participants are asked to place the glass in the pattern Dennis designed on Monday and Tuesday. He will complete the window in the following days. The stained glass window project can be found in Hall B.

This window was designed for Elk River Lutheran Church in Elk River, Minn. This is a congregation under development that was formed when Central Lutheran Church in Elk River voted to leave the ELCA. This dedicated group that chose to remain in the ELCA moved quickly to provide worship and keep an ELCA presence in Elk River. Initially, the group of just over 100 people met at Holy Trinity Episcopal Church for worship on Sunday evenings, but they outgrew that space within a matter of months. The Rev. Cyndi Ganskow-Wold was called to be the mission developer, and a storefront rental space was found for a church home. Elk River Lutheran Church has continued to grow rapidly and, today, this congregation under development has over 300 people in worship and just moved into its own building on the banks of the Mississippi River, purchased on its behalf by the Mission Investment Fund. In gratitude for Elk River Lutheran Church's commitment to the ELCA and in celebration of the ELCA's 25th anniversary, this stained glass window will be displayed in Elk River Lutheran Church's new location.

Women of the ELCA Reception

Come learn about the exciting ministries of Women of the ELCA, mingle, and chat with Jennifer Michael, Women of the ELCA president, and Linda Post Bushkofsky, executive director, and enjoy light refreshments. All voting members and guests of the assembly are invited to this reception on Thursday, August 15 6:30 P.M. – 8:30 P.M. in room 306/307 of the convention center.

Lutheran Men in Mission Reception

The vision of Lutheran Men in Mission is "for every man to have a growing relationship with Jesus Christ through an effective men's ministry in every congregation." Come and enjoy refreshments while visiting with Lutheran Men in Mission leaders and hear about how to engage more men more deeply in your congregation's ministry on Wednesday, August 14 at 7:30 P.M. in room 306/307 of the convention center. You'll see Lutheran Men in Mission's most current resources and be informed about the life changing "One Year to Live" retreats, the congregational ministry "Building Men for Christ" workshops, and the 2014 Lutheran Men's Gathering, "Guys, Guts, and God's Glory" in Nashville, Tenn.

Book Signings with the Chilstroms

The Rev. Dr. Herbert W. Chilstrom, first presiding bishop of the ELCA (1987-1995), and his wife, the Rev. E. Corinne Chilstrom, will be signing copies of two books on Thursday and Friday. A *Journey of Grace: The Formation of a Leader and a Church*, is former bishop Chilstrom's autobiography. Its major focus is on the formation and early years of the ELCA. It is an excellent resource for this 25th anniversary year of the ELCA. A copy is appropriate for every congregation's library. *Every Morning New*, a devotional book co-authored by the Chilstroms, has inspirational readings for every day of the year, together with suggested Bible readings. Many of the daily offerings reflect on the Chilstroms' experiences in the life of the church in the United States and abroad. All income from these books goes to

the New Testament studies program at the Lutheran School of Theology at Chicago. The books are located outside Hall B near registration.

Materials

Assembly Materials: *Pre-Assembly Report*

Reports to the Churchwide Assembly, proposed action items, and background information published in the *2013 Pre-Assembly Report* have been posted on the ELCA website and in the ELCA Guidebook application. Reports were distributed by mail to voting members who requested paper copies. Voting members who did not receive the *2013 Pre-Assembly Report* and requested a paper copy may inquire at the Assembly Office in room 333.

During the course of the assembly, the Guidebook application will be updated with various materials for assembly members (paper copies will also be available in limited quantities), as directed by the secretary of this church. Such materials include reports and updates from assembly committees and other items that have been approved for distribution to the assembly.

The assembly's Rules of Organization and Procedure stipulate that "materials may be distributed on the floor of the assembly only with the written consent of the secretary of this church. In cases where the secretary does not consent, appeal may be made to the Reference and Counsel Committee. That committee's decision shall be final."

Legislative Update

Each day the Office of the Secretary will produce a brief "Legislative Update." The update will contain the wording of any action that was passed by the assembly during the plenary sessions the previous day. If debate on an action is not complete, the update also will detail the action on the floor at the time the debate ceased and the context for that action. Voting members will then be informed regarding when the debate will resume. These updates will be uploaded to the Guidebook and www.elca.org/assembly each day.

Minutes

A concise summary of assembly actions will be available immediately after the closing of the assembly. Preliminary minutes of the 2013 Churchwide Assembly will be available online upon their completion in September. The *Reports and Records: Assembly Minutes* will be available for distribution early in 2014 and will also be posted on the website.

Name Badges

Admittance to certain areas of the plenary hall of the assembly will be by color-coded badges, provided for all registrants as follows:

Yellow	Voting Members
Blue	Advisory Members Church Council Board Chairs Administrative Team Faculty Resource Persons Non-Voting Members ELCA Seminary Presidents ELCA College/University Presidents

Purple	Ecumenical Guests Former Churchwide Officers Resource Members Bishops' Spouses Congregation Observers Regional Coordinators Synodical Officers Synodical Staff
Green	Assembly Staff Contractors ELCA Unit Staff Local Arrangements Committee Minutes Team Musicians Worship Leaders
Red	Accredited News Media
Gray	Visitors
White	Volunteers

Assembly participants are required to display name badges when attending all assembly-related events.

Meals

Voting and advisory members will not receive meal tickets for this assembly. Instead, their name badge will act as a ticket for all meals, which is received at registration.

There will be several meals throughout the assembly for which participants are on their own. Voting and advisory members will receive a meal card during registration which can be used like a cash card to pay for these meals.

To find local dining options near the convention center, a mobile app is available from the Apple App Store and Google Play for free. Search "Pittsburgh Convention" in the app store to download this app. View restaurants, parking, hotels, and attractions within a 15-minute walk to the convention center.

Breakfast

Assembly participants are on their own for breakfast each day.

Lunch

Voting and advisory members and participants who purchased meals will be served lunch beginning at 12:00 NOON in Hall B of the David L. Lawrence Convention Center Tuesday, August 13 – Saturday, August 17.

Dinner

Voting and advisory members and participants who purchased meals will be served dinner in Hall B on Monday, August 12 at 6:00 P.M. Dinner will also be served on Tuesday, August 13 at 6:00 P.M. and at the 25th Anniversary Celebration on Friday, August 16 at 6:30 P.M. in the Spirit of Pittsburgh Ballroom of the convention center. All other dinners will be on your own.

People Helping People

Cellphones

Please remember to turn off the ringer on all cellphones and mute iPads and other tablet devices while in the plenary hall throughout the course of the assembly. According to the Rules of Organization and Procedure, the use of computers and other electronic devices, such as cellphones (in texting mode only), smartphones, tablets, and other wireless electronic communication devices is allowed in the plenary hall during assembly sessions, provided that such devices are in a silent mode and do not disturb voting members. Speaking on any device is prohibited in the plenary hall during assembly sessions. Members and others are expected to be courteous and respectful and are encouraged to leave the hall if they intend to engage in communication activities that may disturb others or are not related to the work of the assembly. Use of computers and other electronic devices is precluded during worship.

Non-Smoking Policy

Smoking is prohibited throughout the David L. Lawrence Convention Center. This includes outside balconies, decks, and terraces.

Special Needs

Guests who have special needs but did not have the opportunity to alert staff of the Office of the Secretary prior to registration should inquire at the registration desk outside Hall B.

Living Well—All Week Long

Portico Benefit Services is at the assembly to help participants tend to their well-being throughout the Churchwide Assembly—in all aspects of the Wholeness Wheel.

The Wholeness Wheel reminds everyone to care for the whole self by centering on faith and making efforts to tend to the many aspects in life: social/interpersonal, emotional, physical, financial, vocational, intellectual, and spiritual.

Ideas for Living Well

Use the Wholeness Wheel as a daily guide. Stop by the Portico Benefit Services table in Hall B and pick up information about the Wholeness Wheel—along with some ideas about how to live well—throughout the assembly.

For example:

- find time for devotions and listening to God;
- listen to new ideas and ways of thinking;
- stretch and walk during breaks and between sessions;
- eat healthy food and stay hydrated; and
- exercise good stewardship of human, financial, and environmental resources.

Stretch and Pray

Join Bishop Murray D. Finck of the Pacifica Synod from 6:15 A.M. to 6:45 A.M., August 13–16, for low-impact stretching and “high-impact” prayer in the convention center, floor 2, next to registration.

Bishop Finck will direct participants as he introduces each new posture, stretch, or exercise. He also will teach some deep-breathing exercises. The sessions will end with six prayer postures—adoration, confession, absolution, petition, intercession, and contemplation.

Wear comfortable, loose-fitting clothing. Also, please bring a towel for the floor.

Parish Nurses

Two nurses will be available Monday through Saturday at the Comfort Station in Hall B. These certified parish nurses have volunteered their time and are available to answer any questions or respond to health concerns you may have during the assembly. Comfortable chairs are provided for assembly participants in private, screened areas.

Emergency Medical Technicians

Medics will be available throughout the week to assist with the various medical situations that occur from serious emergencies to minor cuts. They are located next to the Comfort Station in Hall B. They will be available the following hours:

Monday, August 12	7:30 A.M. – 9:00 P.M.
Tuesday, August 13	7:30 A.M. – 8:00 P.M.
Wednesday, August 14	7:30 A.M. – 7:30 P.M.
Thursday, August 15	7:30 A.M. – 7:30 P.M.
Friday, August 16	7:30 A.M. – 9:00 P.M.
Saturday, August 17	7:30 A.M. – 4:00 P.M.

In case of a serious medical emergency, dial 911 from your cell phone.

Worship

Gathered by the Holy Spirit around the means of grace in worship, we are rooted and nourished by God's grace through Word and Sacrament.

The readings for worship have been chosen to supplement the assembly theme of being deeply rooted and always being made new. This week we will hear of renewal through the work of the Holy Spirit, reconciliation and renewed relationships in the community of faith, and God's call for our participation in that work. We will also mark the Commemorations of Florence Nightingale and Clara Maass, renewers of society, and Maximilian Kolbe and Kaj Munk, martyrs, as well as celebrate the festival day, Mary, Mother of our Lord. The readings appointed for these days are from the church's calendar, and they proclaim to us God's continued work of renewal in our world. In biblical stories, letters, and poetry, through water, bread and wine, in our shared experience in the worship life of this assembly we are formed as a community, the gathered church, inspiring faith, and always making things new in Jesus Christ.

Services of Holy Communion will be held in Hall C each day of the assembly. Prayer and singing will bracket each business session in the plenary hall.

Assembly Worship Staff

Pr. Brian Evans, First English Evangelical Lutheran Church, Pittsburgh, Pa.

Pr. Erin Evans, Peace Evangelical Lutheran Church, Greenock, Pa.

Pr. Betty Krafft, Pastor, St. Peter Lutheran Church, Spokane, Wash.

Ms. BethAnn Lynch, ELCA Churchwide Office, Assistant for Worship

Pr. John Morris, Pastor, Prince of Peace Lutheran Church, Dublin, Ohio

Pr. Peter Perella, ELCA Churchwide Office, Director for Worship

Pr. Martin Seltz, Augsburg Fortress, Publisher for Worship

Mr. Scott Weidler, ELCA Churchwide Office, Program Director for Worship and Music

Mr. John Weit, Cantor, Trinity Lutheran Church, Worcester, Mass.

Pr. Steven Wilco, Pastor, Immanuel Lutheran Church, Amherst, Mass.

Music Leaders

Throughout the assembly, music will be led by many talented musicians, including: Kari Files, AiM, is Minister of Music at Bethany Lutheran Church, Minot, N.D., organ instructor at Minot State University and band instructor for Minot Public Schools; Paul Friesen-Carper, cantor at Trinity Lutheran Church, Richmond, Mich., has arrangements of ELW Holy Communion Settings 6 & 8 published by Augsburg Fortress; Ruth Ideen-Sall is a professional singer in the Philadelphia area

specializing in oratorio and art song and serves as director of Children's Choirs and ministries at Abington Presbyterian Church, Abington, Pa.; John Sall is director of Music Ministries at Abington Presbyterian Church. He enjoys varied opportunities as a percussionist, accompanist, and organist in addition to his conducting and teaching roles; Daniel Schwandt is the cantor to the Seminary Community at the Lutheran School of Theology at Chicago and the cantor of Augustana Lutheran Church of Hyde Park and Lutheran Campus Ministry; Craig Schweitzer serves as pastor of Worship & Youth Education at Good Shepherd Lutheran Church in Bismarck, N.D.

Monday musicians will also include The Bach Choir of Holy Trinity, the oldest fully professional choir in residence in a Lutheran Church in the United States, under the direction of Cantor Rick Erickson and Associate Director of Music Donald Meineke. With a distinguished 46-year history, the choir consists of some of the finest choral singers in the country and specializes in the music of the historic Lutheran tradition. Hailed as "New York's Temple to Bach" the Bach Choir, along with the Bach Players, presents weekly Sunday Vespers from October to May featuring the appointed Bach cantata and drawing on the extensive wealth of German motet literature. The Bach Choir may be heard in two CD releases, *Joining Hearts and Voices* and *Bach for All Seasons*, both produced with Augsburg Fortress, and each nominated for a Grammy. The latest release is *Freud und Lust*, solo cantatas by Buxtehude and Bach featuring the Bach Players and countertenor, Ryland Angel. [www.bachvespersnyc.org] Soprano: Sarah Brailey, Franny Geller, Anna Hasek Bell, Anna Lenti; Countertenor: Ryland Angel, John Bradford Bohl, Brennan Hall; Tenor: John Kawa, Donald Meineke; Bass: Joe Chappel, Malcolm Merriweather, Joe Beutel.

The Iron City Brass Quintet is comprised of recent graduates of Duquesne University and Carnegie Mellon University: Erin Yanacek, Kenton Bandy, Mark Addleman, Aaron Pisula, and John DiCesare. All five members are active freelance musicians in the Pittsburgh area, and they perform together frequently.

Tuesday musicians will also include Margaret, Stephen, and Beth Folkemer who play with the band, Dearest Home, specializing in Civil War era music and traditional Pennsylvania songs. Joining them this day are Mark Oldenburg, Julie Stecker, and Joel Folkemer. They have often played together at Christ Lutheran Church in Gettysburg, Pa. The fiddler is Carl Rahkonen, music librarian and professor at Indiana University, Pa.

Wednesday musicians will include the Assembly Choir and also Paris Dominique Brown, soprano, who was born and raised in Chicago, Ill., but is currently a member of Zion Lutheran Church in Appleton, Wis. Paris works as the director of conservatory admissions at Lawrence University. When she is not recruiting music students for college, she enjoys serving as cantor for worship and volunteering part of her summers teaching music in Haiti.

Thursday musicians will include the Assembly Choir and also Sandra Montes, who is a singer/songwriter and worship leader at Iglesia Episcopal San Mateo in Houston, Texas. She has recently completed her tenure as a member of the Standing Commission on Liturgy and Music of The Episcopal Church.

Saturday musicians will include singers and instrumentalists from area congregations.

Assembly Choir

Voting members and guests of the assembly are invited to join the Assembly Choir, singing for the services of Holy Communion on Wednesday, Thursday, and Friday. Those who did not have the opportunity to volunteer when they registered for the assembly may join the choir by attending rehearsals in the choir area near the organ and piano in Hall C. The choir rehearsals are Tuesday and Thursday, both from 12:00 NOON – 12:45 P.M.

Prayer Writers

A team of pastors and lay people from across the ELCA prepared the Prayers of Intercession for our services of Holy Communion and some of the prayers for the opening and closing of plenary sessions. They include Jennifer Baker-Trinity, Pamela Fickenscher, Kyle Schiefelbein, and Kevin Shock.

Offering Designations

An offering will be received at each daily worship service. Offerings will benefit:

ELCA Malaria Campaign (Monday)
ELCA New Congregations (Tuesday)
ELCA Fund for Leaders (Wednesday)
ELCA Global Church Sponsorship (Thursday)
ELCA World Hunger (Friday)
Lutheran Disaster Response (Saturday)

Please make checks payable to the Evangelical Lutheran Church in America (ELCA). No offering envelopes will be available. Donations also can be made via credit card by visiting the following website: www.ELCA.org/donate.

Daily Holy Communion

Monday, August 12 at 7:30 P.M.

Preacher and Presiding Minister:

Assisting Minister:

Reader:

Reader:

Processional Participants:

Processional & Prayer Intercessions:

Bp. Mark S. Hanson, ELCA presiding bishop

Mr. Carlos E. Peña, ELCA vice president

Mr. David D. Swartling, ELCA secretary

Pr. Linda O. Norman, ELCA treasurer

Members of area congregations

Voting members and guests of the assembly

Tuesday, August 13 at 11:00 A.M.

Presiding Minister:

Preacher:

Assisting Minister:

Reader:

Communion Assistants:

Pr. Gabi Aelabouni, Fort Collins, Colo.

Pr. Yehiel Curry, Chicago, Ill.

Ms. Deborah Graf, Reading, Pa.

Ms. Betsy Poor Bear, Scottsbluff, Neb.

Parish nurses from area congregations

Wednesday, August 14 at 11:00 A.M.

Presiding Minister:

Preacher:

Assisting Minister:

Reader:

Pr. Erin Evans, McKeesport, Pa.

Pr. Esther Rajashekar, Wyndmoor, Pa.

Mr. David Rojas Martínez, Frankfort, Ind.

Mr. Gary Gemar, Coeur D'Alene, Idaho

Thursday, August 15 at 11:00 A.M.

Presiding Minister:

Preacher:

Assisting Minister:

Reader:

Pr. George Cruz-Martinez, Orlando, Fla.

Pr. Kristine Carlson, Minneapolis, Minn.

Ms. Adriana Johnson, Houston, Texas

Mr. Tanner Howard, Dubuque, Iowa

Friday, August 16 at 11:00 A.M.

Presiding Minister:

Preacher:

Assisting Minister:

Reader:

Pr. Teresita Valeriano, Alameda, Calif.

Pr. Pedro Suarez, Houston, Texas

Mr. Thomas Madden, Fairport, N.Y.

Ms. Robin McCants, Detroit, Mich.

Saturday, August 17 at 11:00 A.M.

Presiding Minister:

Preacher:

Assisting Minister:

Reader:

Reader:

Processional Participants:

Bp. Mark Hanson, ELCA Presiding Bishop

Bp. Jessica Crist, Montana Synod

Ms. Yolanda Tanner, Baltimore, Md.

Ms. Christine Mwanyika, Grand Rapids, Mich.

Pr. Chienyu Yi, Aurora, Ill.

Members of area congregations

Unless otherwise listed, communion assistants and processional participants are voting members and guests to the assembly. Synodical staff members and regional coordinators will also serve as communion assistants throughout the week.

Food Sensitivities

At each service of Holy Communion, the communion station at the baptismal font provides bread for those with food sensitivities and de-alcoholized wine. Please go to this station only if you require these elements.

The Ener-G Communion Wafers contain filtered water, sweet rice flour, potato flour, palm oil, potato starch, methylcellulose, sunflower lecithin, and Ener-G baking powder (sodium pyrophosphate, sodium bicarbonate, potato starch, and monocalcium phosphate).

Worship Staff Desk

If you have questions about worship leadership assignments, schedules, or other concerns, the worship staff desk will be open the following hours:

Monday 12:30 P.M. – 1:30 P.M.

Tuesday – Friday 10:30 A.M. – 11:00 A.M. & 12:00 P.M. – 12:30 P.M.

The worship desk is located near the Hall B entrance to Hall C on the city side of the hall. You are also welcome to email the worship staff worship@elca.org.

Personal Prayer

A space dedicated for personal prayer and devotion is located on the third floor next to the south terrace. A book is there for you to write prayer requests. Everyone is encouraged to stop by this area regularly and include these requests in your own prayers. During the Prayers of Intercession, at each service of Holy Communion, there will be a brief time for you to voice any prayers you may wish to include aloud or silently.

Art

The artwork on the cover of the worship folders and on the backdrops to the Word and Meal platforms was designed by Stephen B. Starr Design, Inc., Evanston, Ill.

The hanging above the baptismal font was created by Patrick Shebeck, Valerie Dusso, and Kelly Faultsch.

Communion Vessels

The communion vessels were designed and produced at the Pittsburgh Glass Center, a non-profit, public-access school, gallery, and state-of-the-art glass studio on Penn Avenue in Pittsburgh's East End. The Glass Center is an important arts organization in Pittsburgh that is helping the city connect its history as a major producer in glass to its creative future through the innovative use of "glass as art." The Center also stands as a cornerstone to the Penn Avenue Arts Initiative to redevelop an under-utilized part of the city through the arts. In all of its work, the Pittsburgh Glass Center is dedicated to teaching, creating, and promoting glass art.

The artisans at the Center have created 30 four-piece sets of communion vessels out of clear, blown glassware accented with blue on the edges of the chalice (cup), and wound around the top of the flagon (pitcher). The paten (plate) is pressed glass with an image of wheat and grapes in the shape of a cross etched on the bottom. The set also includes a small anointing bowl.

If you purchased a set of communion vessels, please pick your set up at the worship office in Hall C after 2:00 P.M. on Saturday, August 17. The Worship Office will be open until 3:00 P.M. or 30 minutes after the final plenary session, whichever is later. Please allow adequate time to inspect your purchase and sign a receipt.

Caring for Creation

Greening the Churchwide Assembly

Since the social statement *Caring for Creation: Vision, Hope, and Justice* was approved at the 1993 Churchwide Assembly, the ELCA has strengthened its efforts in caring for God's creation. The ELCA seeks to constantly improve its efforts by making each assembly more environmentally friendly.

Green Practices at the Convention Center

The David L. Lawrence Convention Center is the only convention center in the world with LEED® Gold certification in new construction and Platinum certification in existing building by the U.S. Green Building Council. In addition, the convention center has adopted many operational procedures to reduce their carbon foot print. Some of these procedures include recycling, composting, reducing energy use, operating a grey water reclamation plant, growing vegetables and herbs onsite, purchasing green products, and donating unused supplies.

Green Practices of the Caterer

Levy Restaurants, the convention center's exclusive food provider, uses entirely compostable cups, plates, flatware, and packaging, giving event planners the option of 100 percent compostable food service events. By purchasing in bulk and supporting the Buy Fresh, Buy Local program, Levy Restaurants is able to reduce the packaging and transportation costs associated with food purchases.

Furniture

Following the Churchwide Assembly, furniture in the Comfort Station, Augsburg Fortress Event Store, and other areas of the assembly will be donated to a congregation under development in Brookline, Pa., which was started out of a Lutheran-Presbyterian congregation.

Assembly Registration

The Churchwide Assembly registration team reduced dramatically its amount of paper by handling all registrations either online or over the telephone. Correspondence occurred via email whenever possible.

The registration team thanks all participants for this partnership in practicing good stewardship of the environment and other resources. While there are always a few challenges to work out in developing new means of communication, the assembly registration team hopes that it was, on the whole, a positive experience. If there are any suggestions for how the assembly planners can continue greening efforts, please indicate those on the Churchwide Assembly evaluation form which participants will receive at the final plenary session.

ELCA Guidebook Application

For the first time, all voting members were given the option to receive their *Pre-Assembly Report* through the ELCA Guidebook application. Instead of receiving a paper copy of the *Pre-Assembly Report*, these participants are using iPads provided on loan or their own tablet device to view the report. This has saved thousands of sheets of paper and great reduced the assembly's carbon footprint by not mailing them to each voting member this year. We thank the staff of Information Technology for developing the project to make this a usable technology.

Reuse

Several items were collected at the end of the 2011 Churchwide Assembly and will be reused for this assembly. The red volunteer vests, which were made by Latina women new to the United States, have been loaned to synod assemblies and will be used again for this assembly. Many of the binders were also collected at the last assembly to be reused. Over 500 name badges were collected and cleaned to be reused by the volunteers.

At the end of the assembly, volunteers will once again be collecting items to reuse at the 2016 Churchwide Assembly, so if you do not want to take these items with you, please leave them on the tables.

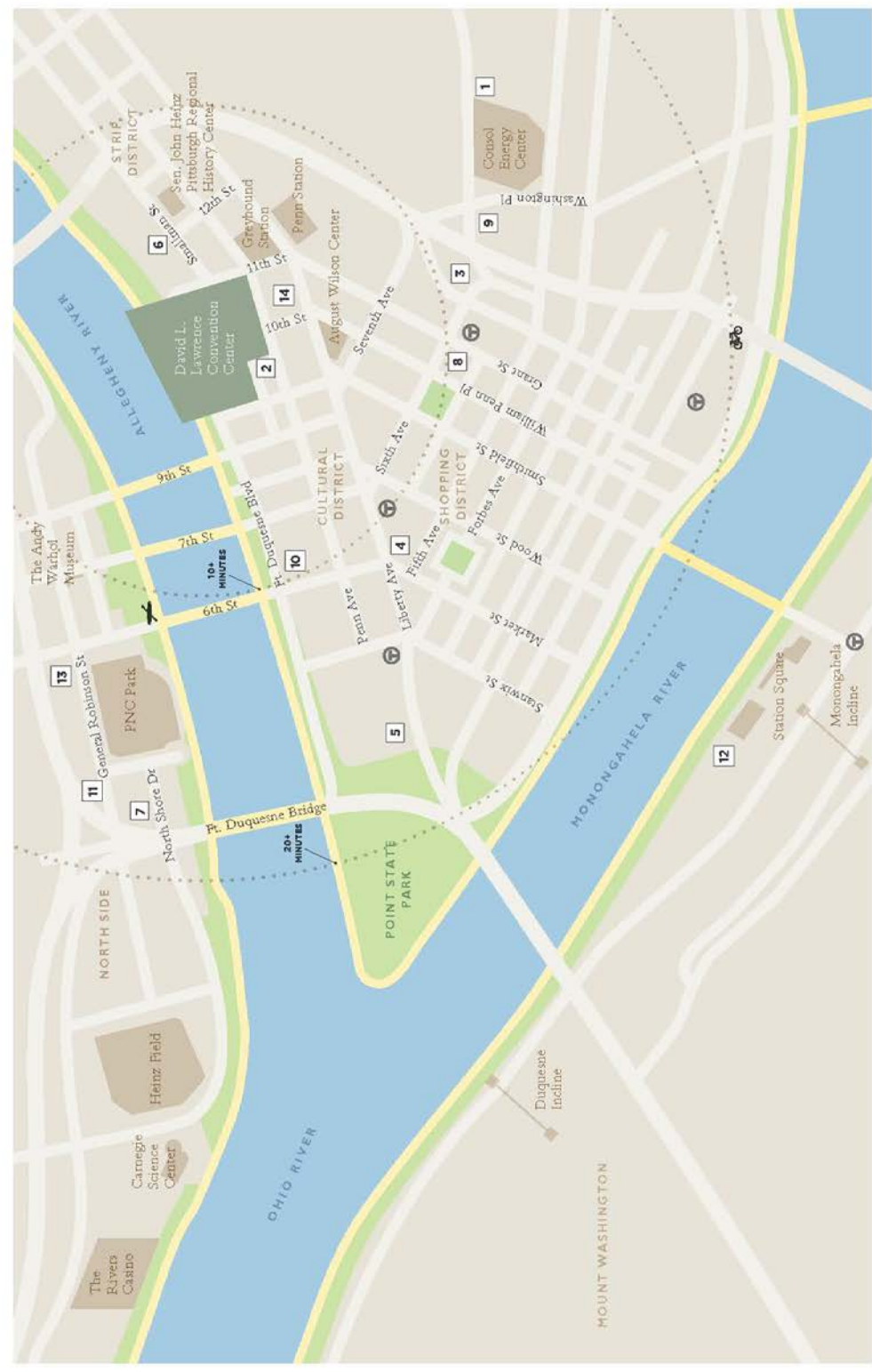

Pittsburgh hotels within walking distance of the David L. Lawrence Convention Center

- | | |
|---|--|
| 1 Cambria Suites Pittsburgh at Consol Energy Center 1320 Centre Avenue | 10 Renaissance Pittsburgh Hotel 107 Sixth Street |
| 2 Courtyard by the Marriott Pittsburgh Downtown 945 Penn Avenue | 11 Residence Inn Pittsburgh North Shore 574 West General Robinson Street |
| 3 DoubleTree by Hilton Hotel & Suites Pittsburgh Downtown One Bigelow Sq. | 12 Sheraton Station Square Hotel 300 W. Station Square Drive |
| 4 Fairmont Pittsburgh 510 Market Street | 13 Springhill Suites by Marriott North Shore 223 Federal Street |
| 5 Wyndham Grand Pittsburgh Downtown Hotel 600 Commonwealth Place | 14 Westin Convention Center Pittsburgh 1000 Penn Avenue |
| 6 Hampton Inn & Suites Pittsburgh Downtown 1247 Smallman Street | Subway Stations |
| 7 Hyatt Place Pittsburgh North Shore 260 North Shore Drive | Three Rivers Park Trail |
| 8 Omni William Penn Hotel 530 William Penn Place | Bike rental |
| 9 Pittsburgh Marriott City Center 112 Washington Place | Kayak rental |



For bus schedules and maps, visit portauthority.org

DAVID

SMALLMAN
STRIP DISTRICT

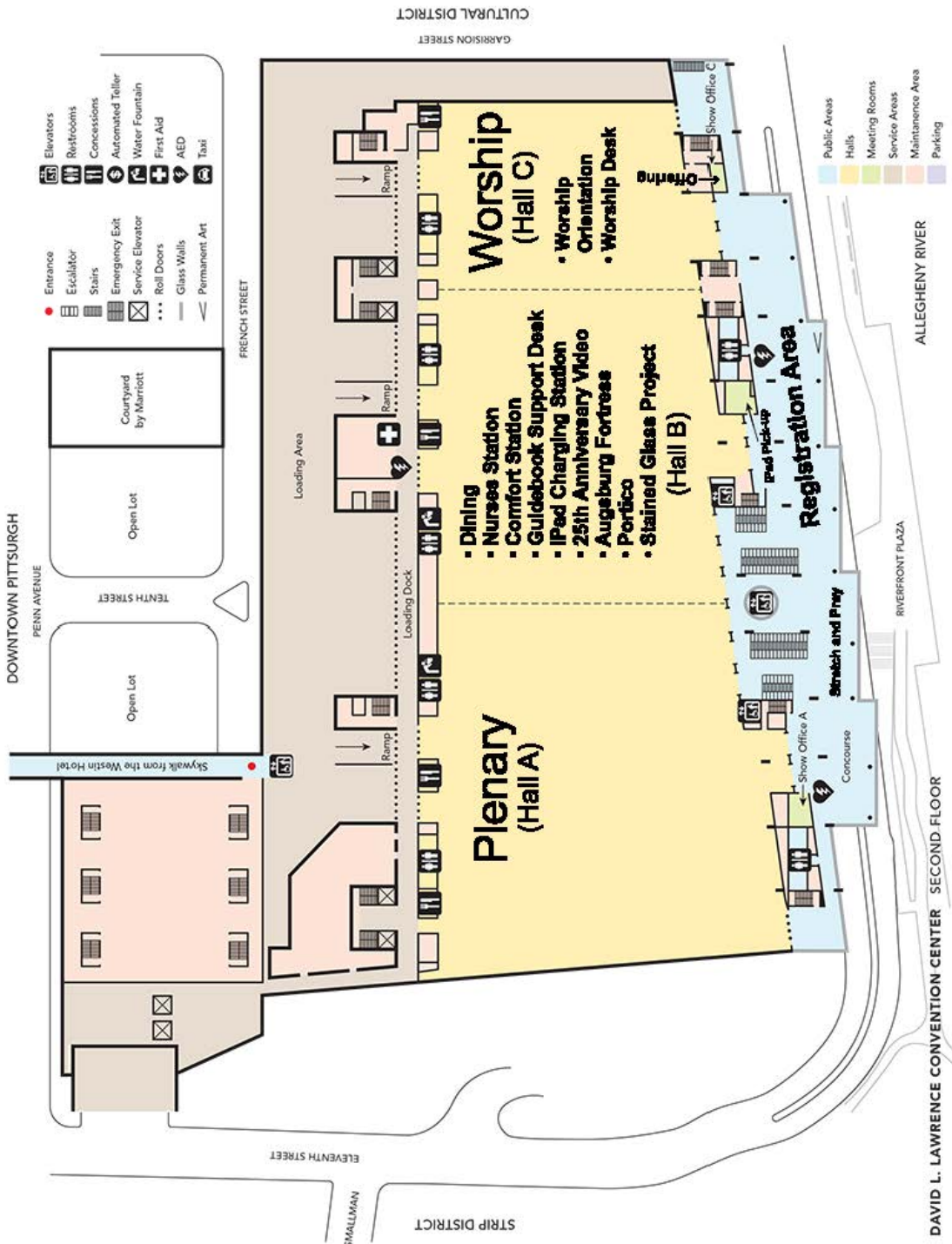

Seating Chart Key

Synods

1A:	Alaska Synod	7A:	New Jersey Synod
1B:	Northwest Washington Synod	7B:	New England Synod
1C:	Southwestern Washington Synod	7C:	Metropolitan New York Synod
1D:	Eastern Washington-Idaho Synod	7D:	Upstate New York Synod
1E:	Oregon Synod	7E:	Northeastern Pennsylvania Synod
1F:	Montana Synod	7F:	Southeastern Pennsylvania Synod
2A:	Sierra Pacific Synod	7G:	Slovak Zion Synod
2B:	Southwest California Synod	8A:	Northwestern Pennsylvania Synod
2C:	Pacifica Synod	8B:	Southwestern Pennsylvania Synod
2D:	Grand Canyon Synod	8C:	Allegheny Synod
2E:	Rocky Mountain Synod	8D:	Lower Susquehanna Synod
3A:	Western North Dakota Synod	8E:	Upper Susquehanna Synod
3B:	Eastern North Dakota Synod	8F:	Delaware-Maryland Synod
3C:	South Dakota Synod	8G:	Metropolitan Washington, D.C., Synod
3D:	Northwestern Minnesota Synod	8H:	West Virginia-Western Maryland Synod
3E:	Northeastern Minnesota Synod	9A:	Virginia Synod
3F:	Southwestern Minnesota Synod	9B:	North Carolina Synod
3G:	Minneapolis Area Synod	9C:	South Carolina Synod
3H:	Saint Paul Area Synod	9D:	Southeastern Synod
3I:	Southeastern Minnesota Synod	9E:	Florida-Bahamas Synod
4A:	Nebraska Synod	9F:	Caribbean Synod
4B:	Central States Synod		
4C:	Arkansas-Oklahoma Synod		
4D:	Northern Texas-Northern Louisiana Synod		
4E:	Southwestern Texas Synod		
4F:	Texas-Louisiana Gulf Coast Synod		
5A:	Metropolitan Chicago Synod		
5B:	Northern Illinois Synod		
5C:	Central/Southern Illinois Synod		
5D:	Southeastern Iowa Synod		
5E:	Western Iowa Synod		
5F:	Northeastern Iowa Synod		
5G:	Northern Great Lakes Synod		
5H:	Northwest Synod of Wisconsin		
5I:	East-Central Synod of Wisconsin		
5J:	Greater Milwaukee Synod		
5K:	South-Central Synod of Wisconsin		
5L:	La Crosse Area Synod		
6A:	Southeast Michigan Synod		
6B:	North/West Lower Michigan Synod		
6C:	Indiana-Kentucky Synod		
6D:	Northwestern Ohio Synod		
6E:	Northeastern Ohio Synod		
6F:	Southern Ohio Synod		

Other Members and Guests

A	Churchwide Officers
B	Resource Members – staging area
C	Church Council Members
D	Chairs of Committees and Boards, Executive Directors of Churchwide Units
E	Office of the Presiding Bishop Staff and Separately Incorporated Ministries Leadership
F	Resource Members
G	Invited Guests
H	Ecumenical and International Guests
I	Seminary Faculty Resource Persons
J	Seminary Presidents
K	ELCA College and University Presidents
L	Unit Staff
M	Accredited News Media
N	Bishops' Spouses
O	Regional Coordinators
P	Synodical Officers and Staff Members
Q	Congregational Observers
R	Secretary's Deputy
S	Assembly Staff Members

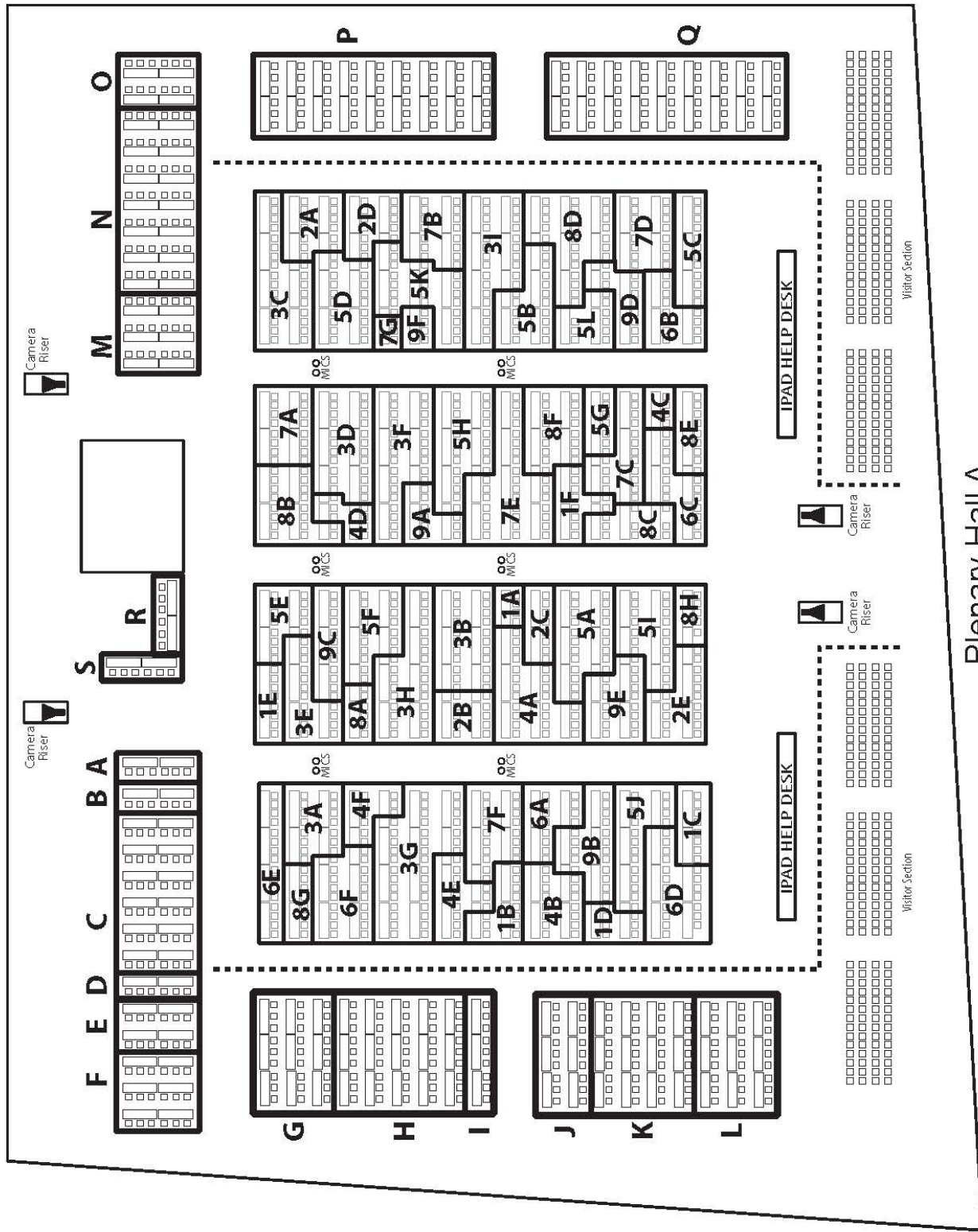

Plenary Hall A